

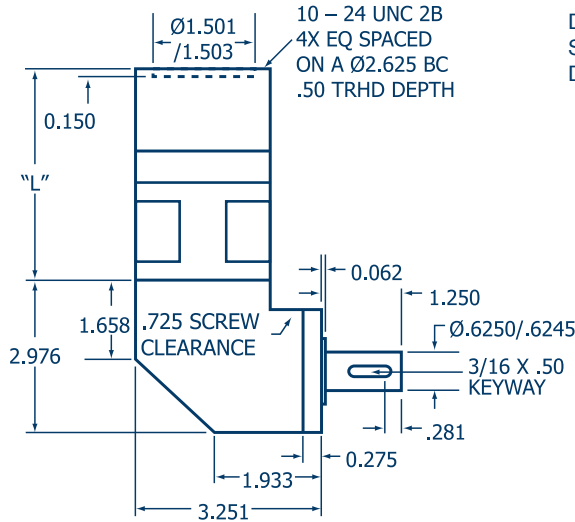

**23RP**

**SPECIFICATIONS**



**DIMENSION "L"**

Single Stage (3:1 to 10:1) = 3.146 ± .015

Double Stage (16:1 to 100:1) = 4.249 ± .015

Part #	Ratio	Continuous output torque at 1500 rpm input (in-lbs)	Continuous output torque at 3500 rpm input (in-lbs)	Continuous output torque at 5000 rpm input (in-lbs)	Gearhead inertia at input (lb-in-sec <sup>2</sup> )	
<b>SINGLE STAGE</b>	23RP003	3:1	280	280	273	2.94 x 10 <sup>-4</sup>
	23RP004	4:1	280	280	280	1.49 x 10 <sup>-4</sup>
	23RP005	5.5:1	280	280	280	7.77 x 10 <sup>-5</sup>
	23RP007	7:1	280	280	280	5.09 x 10 <sup>-5</sup>
	23RP010	10:1	280	280	253	2.90 x 10 <sup>-5</sup>
<b>DOUBLE STAGE</b>	23RP016	16:1	350	350	350	5.93 x 10 <sup>-5</sup>
	23RP022	22:1	350	350	350	3.02 x 10 <sup>-5</sup>
	23RP028	28:1	350	350	350	2.16 x 10 <sup>-5</sup>
	23RP040	40:1	350	350	350	1.46 x 10 <sup>-5</sup>
	23RP049	49:1	350	350	350	1.96 x 10 <sup>-5</sup>
	23RP055	55:1	350	350	350	1.39 x 10 <sup>-5</sup>
	23RP070	70:1	350	350	350	1.36 x 10 <sup>-5</sup>
	23RP100	100:1	350	350	350	1.35 x 10 <sup>-5</sup>

**GENERAL SPECIFICATIONS**

Construction Type	Ratio	Backlash: Standard (arc-minutes)	Backlash: Low Backlash (arc-minutes)	Efficiency	Weight (lbs)	Maximum Tested Input rpm
Single Stage	3:1 to 10:1	10	7	90%	4.63	5000
Double Stage	16:1 to 100:1	14	11	85%	5.88	5000

**PEAK TORQUE:** 15% above continuous rating.

**NOTE:** Repeated peak torque loading may cause failure.